

**Muncy™ Casing Thimbles**

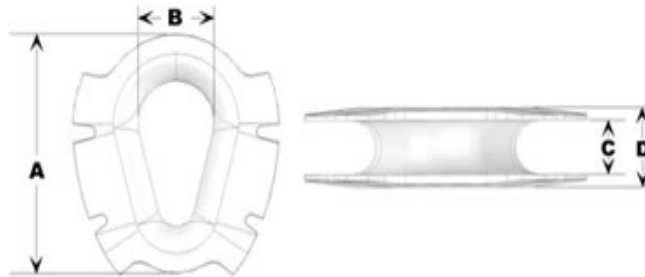

Stock No.	Six Part Rope Size	Eight Part Rope Size	Dimensions			
			A	B	C	D
CT-8	1/4	3/16	4.08	1.47	0.69	1.00
CT-10	5/16	1/4	4.65	1.72	0.81	1.31

**Muncy™ Slip-Through Thimbles**

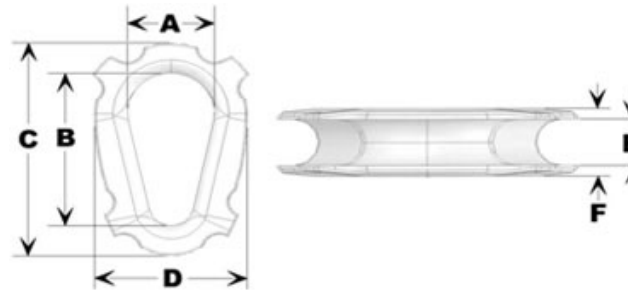

Stock No.	Single Part Rope Size	Six Part Rope Size	Eight Part Rope Size	Dimensions					
				A	B	C	D	E	F
ST-16	1/2 - 9/16	3/16	3/16	2.34	4.38	6.09	4.09	0.69	1.00
ST-20	5/8 - 3/4	1/4 - 5/16	1/4	3.17	6.45	8.60	5.35	0.98	1.31

**Muncy Machine & Tool Company — The Upson-Walton Company**  
P.O. Box 205 / Muncy, PA 17756-0205 / Phone: 800-221-8143 / Fax: 570-649-5850

<a href="#">SB Buttons</a>	<a href="#">NB Buttons</a>	<a href="#">G Buttons</a>	<a href="#">CB Buttons</a>	<a href="#">Drumline Buttons</a>	<a href="#">Logging Ferrules</a>	<a href="#">Grommet Sleeves</a>	
<a href="#">ITS Studs</a>	<a href="#">STS Studs</a>	<a href="#">Threaded Sleeves</a>	<a href="#">Ball Shanks</a>	<a href="#">Shank Hooks</a>			
<a href="#">Open Bridge Sockets</a>	<a href="#">Closed Bridge Sockets</a>	<a href="#">Open Rope Sockets</a>	<a href="#">Open Strand Sockets</a>	<a href="#">Closed Rope Sockets</a>			
<a href="#">Closed Strand Sockets</a>	<a href="#">Anchor Sockets Type 6, 7, 8</a>	<a href="#">Pin Eye Terminals</a>	<a href="#">Fork Terminals</a>	<a href="#">Open Swage Sockets</a>			
<a href="#">Closed Swage Sockets</a>	<a href="#">Boom Pendant Closed</a>	<a href="#">Boom Pendant Open</a>	<a href="#">Carbon Steel Sleeves</a>				
<a href="#">Aluminum Swage Sleeves</a>	<a href="#">Aluminum Buttons</a>	<a href="#">Two-Piece Duplex Sleeves</a>	<a href="#">One-Piece Duplex Sleeves</a>				
<a href="#">Thimbles</a>	<a href="#">S/S Swage Sockets</a>	<a href="#">Stainless Steel Buttons</a>	<a href="#">Stainless Steel Threaded Studs</a>	<a href="#">Dynamometers</a>			